

STETSON UNIVERSITY | Tampa Law Center Map

FIRST FLOOR

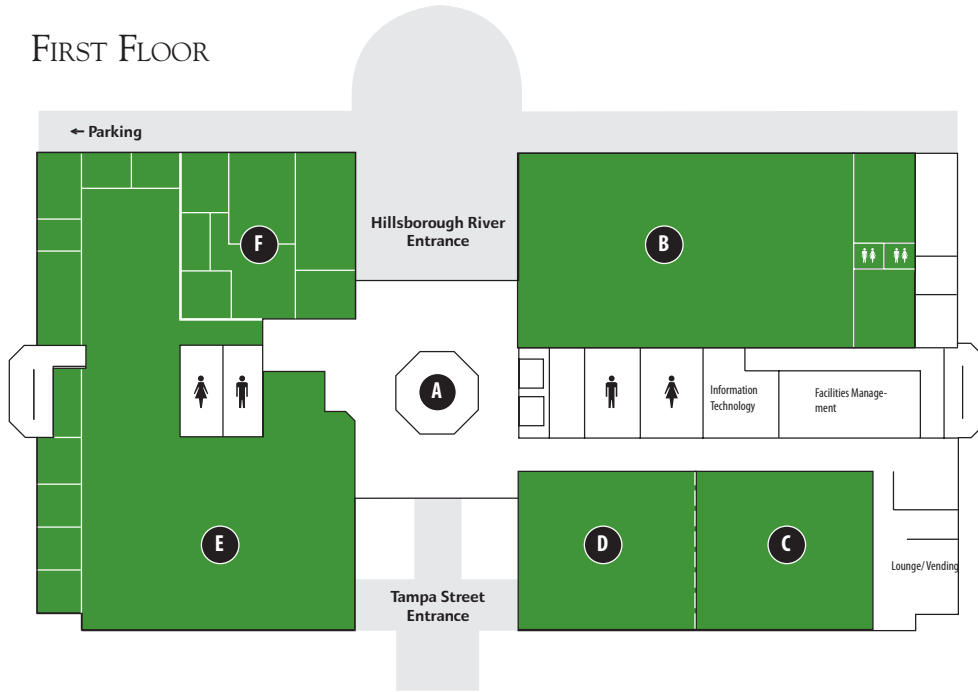

SECOND FLOOR

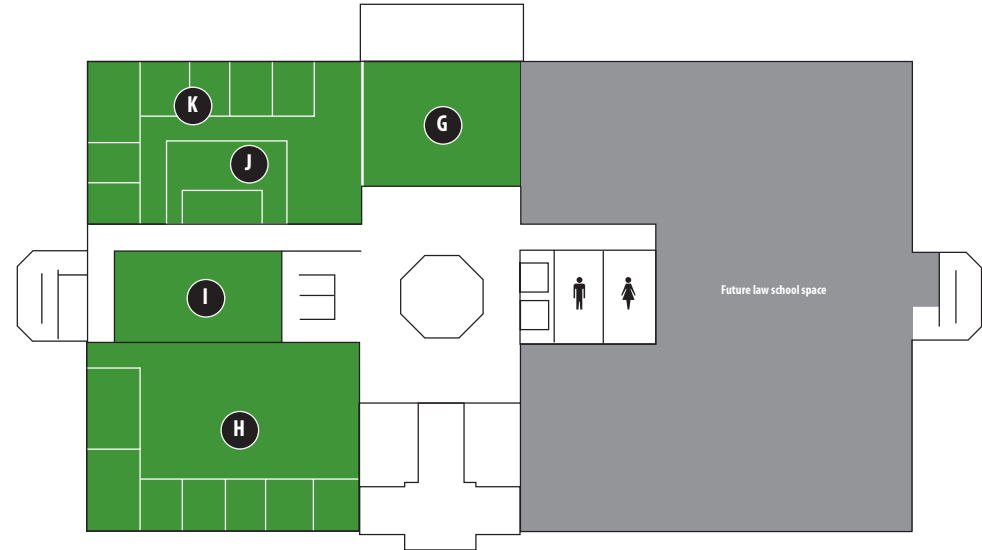

Located at the gateway to downtown Tampa along the Hillsborough River, the Tampa Law Center opened in 2004 as a developing hub for legal activity in the Tampa Bay area. Stetson has been approved to offer 50 percent of the classes for the part-time J.D. degree at the Law Center; in addition, the Tampa branch of Florida's Second District Court of Appeal resides in the building. This public-private partnership between a working court and a law school is the first of its kind in Florida.

The three-story, 73,500-square-foot building reflects the same Mediterranean-Revival architecture of Stetson's Gulfport campus. Stetson's signature tower, modeled after the Torre de Oro in Seville, Spain, is replicated at the top of the Tampa Law Center. Eight friezes, which depict significant scenes from legal history, surround a custom-designed candelabra at the center of the atrium named for the late Dean W. Gary Vause, who acquired the land for the Tampa Law Center. Artwork from a number of Florida artists enhances the building's design.

The Wm. Reece Smith Jr. Courtroom, named for a former president of the American Bar Association who has served on Stetson's part-time faculty since 1954, is shared by the law school and appellate court. The two jury rooms can be used in mock trials to compare the deliberations of different panels. In 2008, Stetson opened a smaller courtroom on the second floor for advocacy classes and competition-team practices.

The Tampa satellite library spans two floors and boasts 16 group study rooms. The library includes a core collection that can be used by law students, judges, and alumni. The spacious reading room on the second floor allows students to study in an engaging environment reminiscent of traditional courthouses and attorneys' offices.

A wireless network connects users to the Internet from anywhere in the building. Every classroom and courtroom is equipped with a touch-screen podium that controls access to extensive audio-visual resources.

First Floor

- A. Dean W. Gary Vause Atrium
- B. Wm. Reece Smith Jr. Courtroom and Jury Rooms
- C. Classroom 135
- D. Classroom 136
- E. Law Library and Study Rooms
- F. Faculty and Administrative Offices for the Dean, Associate Dean and Student Life

Second Floor

- G. Seminar Room
- H. Library Reading and Study Rooms
- I. Courtroom/Seminar Room
- J. Seminar Room 214
- K. Faculty and Staff Offices

Third Floor (not illustrated for security purposes)

- Seminar Room
- Hon. John M. Scheb Conference Room
- Florida's Second District Court of Appeal

Stetson at a Glance

- Ranked first in the nation for trial advocacy and third in legal writing by *U.S. News & World Report*
- Individual attention to student needs
- Accessible professors who excel in their fields
- Advanced classrooms, courtrooms and law library
- Three academic journals, including *Stetson Law Review*
- Centers for Excellence in Advocacy, Elder Law, Higher Education Law and Policy, and International Law
- Home to the Institute for Biodiversity Law and Policy and the Institute for Caribbean Law and Policy
- Honors program for top-ranking students
- One of the first law schools in the U.S. to share space with a working court, the Second District Court of Appeal
- Vibrant campus life with diverse student organizations, interscholastic activities and competitions
- International programs in Argentina, the Cayman Islands, China, England, France, Mexico, the Netherlands, Switzerland and Spain
- The first law school in Florida to require pro bono service by students and faculty
- Dual-degree programs for J.D./M.B.A., J.D./M.P.H., J.D./M.D. and J.D./Grado en Derecho (Spain)
- Championship advocacy teams
- Excellent career development services
- Campuses in beautiful Gulfport and Tampa, Florida

Directions to the Tampa Law Center

From the North or East, take Interstate 275 South to Exit 45A, then get into the right-hand lane. Turn right onto Doyle Carlton Drive, and turn right on Henderson. Turn right again on Tampa Street, and campus will be on your right.

From the South: take Interstate 275 North to Exit 44, then take Scott Street straight. Turn left on Florida Avenue, then turn left on Henderson. Turn left again on Tampa Street, then get immediately into the right hand lane. The campus will be on your right.

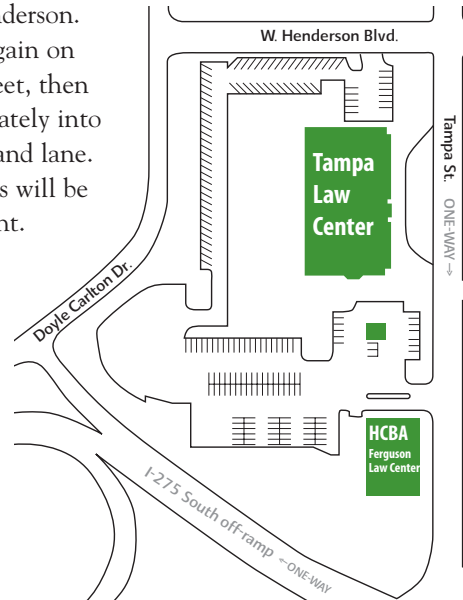

STETSON LAW

Tampa Law Center
1700 N. Tampa St. • Tampa, FL 33602
(813) 228-6625 • www.law.stetson.edu



STETSON
UNIVERSITY

Tampa Law Center
Map

1700 N. Tampa Street
Tampa, Florida 33602
(813) 228-6625
www.law.stetson.edu